

**GENERAL INFORMATION**

- INTERNATIONAL BUILDING CODE (2021)
  - OCCUPANCY: TYPE A5/B
  - TYPE OF CONSTRUCTION: II-B
  - SPRINKLERED AREAS (APPROXIMATE - SEE ARCHITECTURAL PLANS FOR ACTUAL)
    - WET SYSTEM = 22,500 SQ. FT.
    - DRY SYSTEM = 7,300 SQ. FT.
  - DESIGN & INSTALLATION STANDARDS: NFPA-13 (2019)
- SPRINKLER PIPE TYPES:
  - WET-
    - 1" PIPE TO BE SCHEDULE 40 BLACK STEEL W/ THREADED FITTINGS
    - 1-1/4" THROUGH 4" MAINS & BRANCH LINES TO BE BLK SCHEDULE 40 W/ GROOVED FITTINGS
    - MAINS & BRANCH LINES TO BE ROLL-GROOVED BLK SCHEDULE 40
    - 2" AND LARGER TO USE GROOVED SHORT RADIUS FITTINGS
    - ALL FLEX DROPS ARE 48" LENGTH VICTAULIC AH1-CC CONNECTED TO 1" IGS OUTLETS OR 1" VICTAULIC IGS-TO-THREADED PIPE
  - DRY-
    - 1" PIPE TO BE SCHEDULE 40 BLACK STEEL W/ THREADED FITTINGS
    - 1-1/4" THROUGH 4" MAINS & BRANCH LINES TO BE BLK SCHEDULE 40 W/ GROOVED FITTINGS
    - MAINS & BRANCH LINES TO BE ROLL-GROOVED BLK SCHEDULE 40
    - 2" AND LARGER TO USE GROOVED SHORT RADIUS FITTINGS
- DESIGN CRITERIA:
  - LIGHT HAZARD AREAS INCLUDE OFFICE/ADMINISTRATIVE, RESTROOMS, AND CORRIDORS
  - ORDINARY HAZARD GROUP I AREAS INCLUDE MECHANICAL AND ELECTRICAL ROOMS
  - ORDINARY HAZARD GROUP II AREAS INCLUDE ROOMS RESERVED FOR MERCANTILE ACTIVITIES
  - REMOTE AREA REDUCTIONS HAVE BEEN TAKEN WHERE APPLICABLE PER NFPA 13 SEC. 19.3.3.2.3
  - REMOTE AREA INCREASED BY 30% FOR SLOPED CEILING PER NFPA 13 SEC. 19.3.3.2.4
  - REMOTE AREA INCREASED BY 30% FOR DRY SYSTEMS PER NFPA 13 SEC. 19.3.3.2.5
- NOTES:
  - ALL MATERIAL TO BE NEW AND MEET U.L. AND/OR FM STANDARDS
  - HANGERS TO BE INSTALLED IN ACCORDANCE WITH NFPA 13 - SEE PLAN FOR HANGING
  - DRY SYSTEM REQUIREMENTS:
    - DRY SYSTEM PIPE SLOPE INSTALLATION
    - SPRINKLER MAINS TO BE 1/4" PER 10'-0"
    - SPRINKLER BRANCH LINES TO BE 1/2" PER 10'-0"
  - DRY SYSTEM CAPACITY: 533 GALLONS
- SYMBOLS USED ON DRAWINGS:
  - \*x\*FF C PIPE ELEVATION ABOVE FINISH FLOOR
  - \*x\*xTS C PIPE ELEVATION BELOW TOP OF STEEL
  - OH1 ROOM HAZARD CLASSIFICATION (ALL ROOMS ARE CONSIDERED LIGHT HAZARD U.N.O.)
  - SMALL SPACES RULE 10.2.5.2.3 OF NFPA 13 (2019) APPLIED
  - HYDRAULIC CALCULATION JUNCTION POINT
  - 9'-0" CEILING HEIGHT
  - EXPOSED BEAM
  - WET BLACK STEEL PIPE
  - DRY BLACK STEEL PIPE
  - SOLENOID VALVE INSTALLED ON BLACK STEEL PIPE
- SCOPE OF WORK:
  - INSTALL A SINGLE ZONE WET FIRE SPRINKLER SYSTEM TO COVER ALL INTERIOR AREAS OF BUILDING
  - INSTALL A SINGLE DRY FIRE SPRINKLER SYSTEM TO COVER ALL AREAS OF THE BUILDING SUBJECT TO FREEZING
  - ALL AREAS OF THE BUILDING TO BE INSTALLED AND COVERED IN ACCORDANCE WITH THE LOCAL AUTHORITY HAVING JURISDICTION AND PER NFPA 13

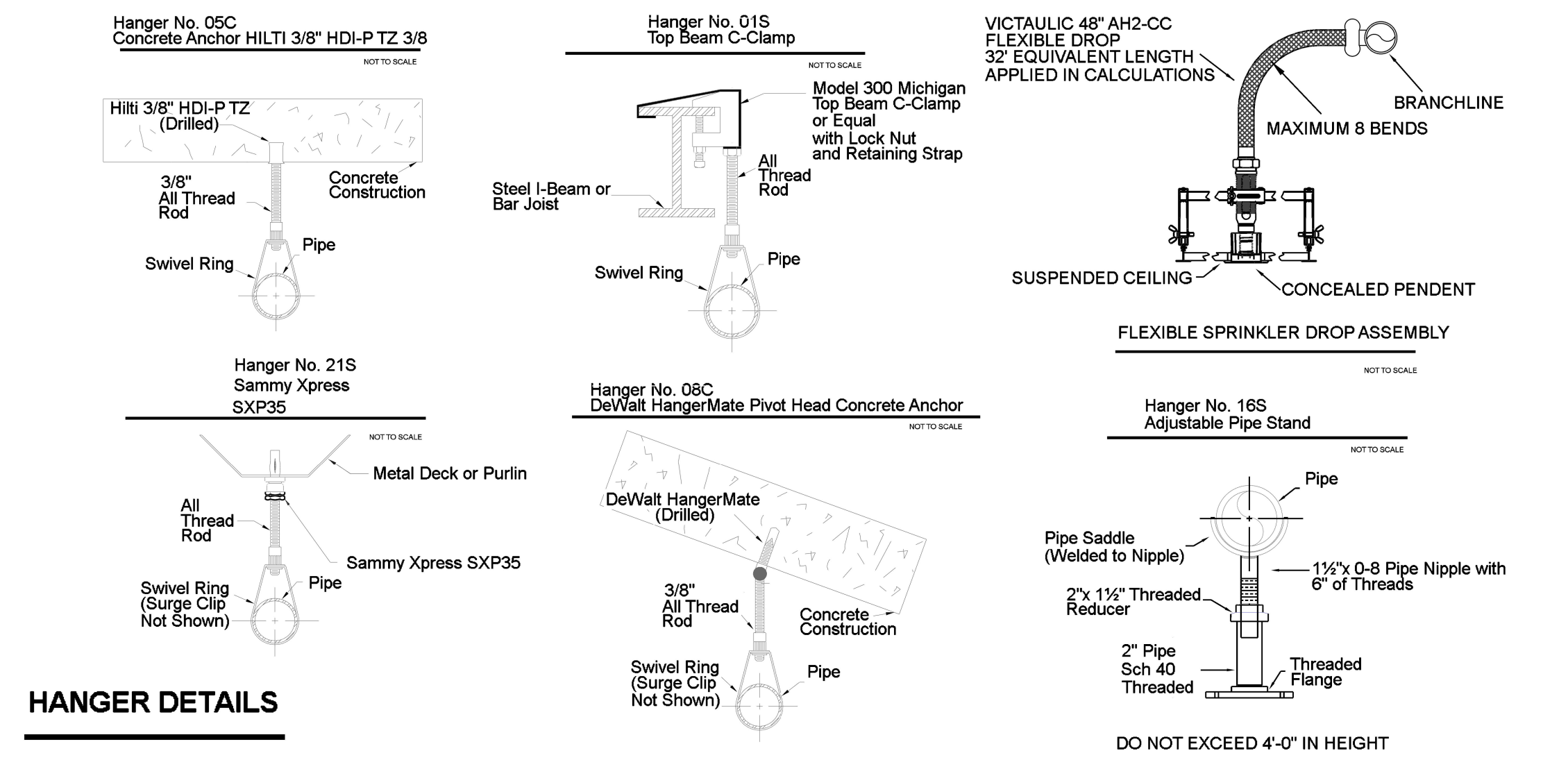
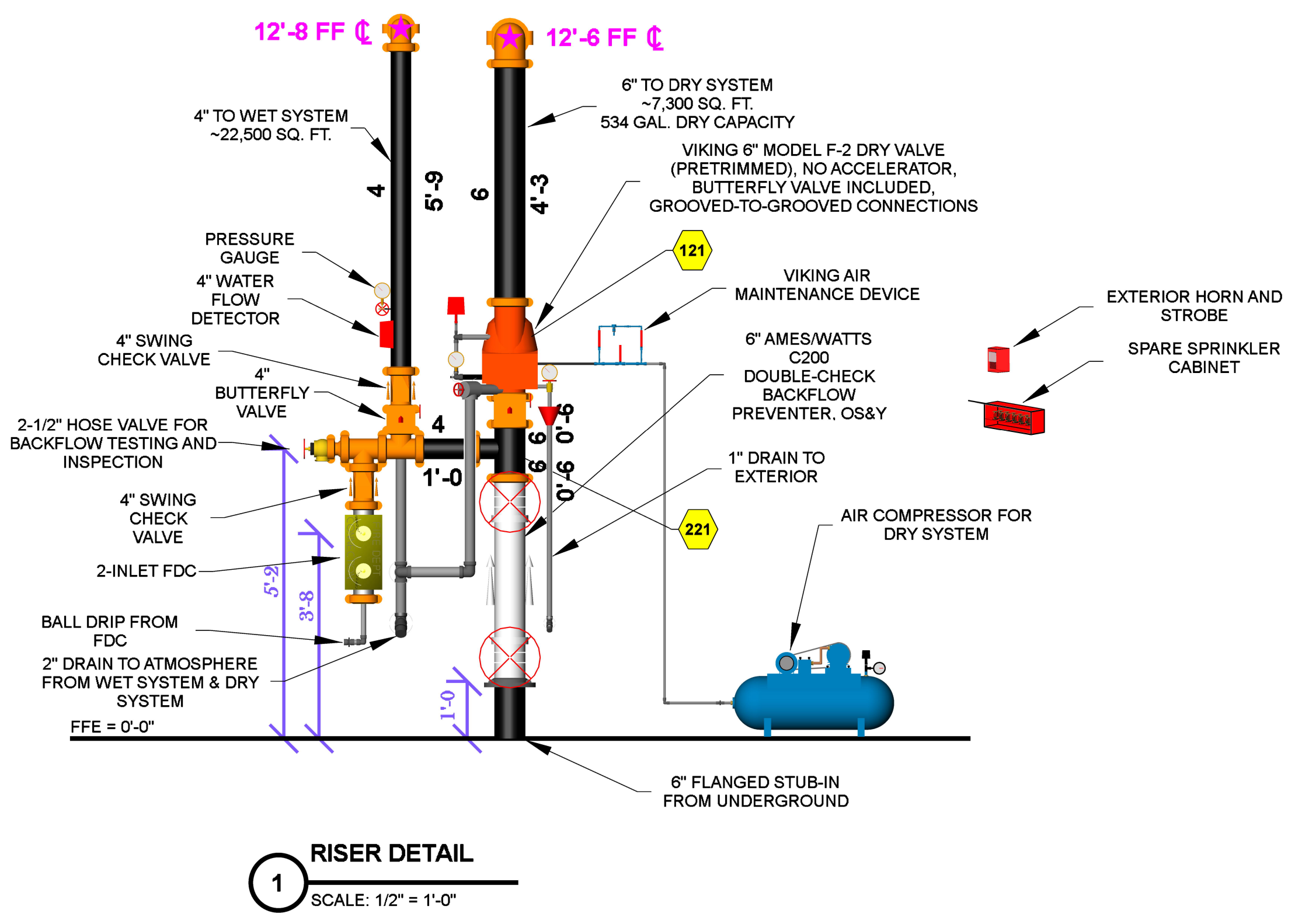

**MAXIMUM DISTANCE BETWEEN HANGERS (FT.-IN.)**

	3/4"	1"	1 1/4"	1 1/2"	2"	2 1/2"	3"	4"	6"	8"
STEEL PIPE EXCEPT THREADED LIGHTWALL	NA	12-0	12-0	12-0	15-0	15-0	15-0	15-0	15-0	15-0
THREADED LIGHTWALL STEEL PIPE	NA	12-0	12-0	12-0	12-0	NA	NA	NA	NA	NA

**Sprinkler Legend**

Symbol	Manufacturer	SIN	Model	Quantity	K-Factor	Type	Size	Response	Finish	Temp	MAX. Spacing	Notes
⊗	Viking	VK300	Microfast	119	5.6	Upright	1/2"	Quick	Brass	200°F	15' x 15'	N/A
●	Viking	VK4621	Microfast	147	5.6	Concealed Pendant	1/2"	Quick	Brass	200°F	15' x 15'	WHITE PLATE
⊙	Viking	VK302	Microfast	7	5.6	Pendant	1/2"	Quick	Brass	200°F	15' x 15'	N/A
⊥	Tyco	TY5330	DS-3	2	11.2	Horizontal Sidewall	1"	Standard	Brass	200°F	16' X 20'	DRY BARREL
⊢	Viking	VK305	Microfast	1	5.6	Horizontal Sidewall	1/2"	Quick	Brass	200°F	14' X 14'	N/A
				Total =	276							

**1 RISER DETAIL**  
SCALE: 1/2" = 1'-0"

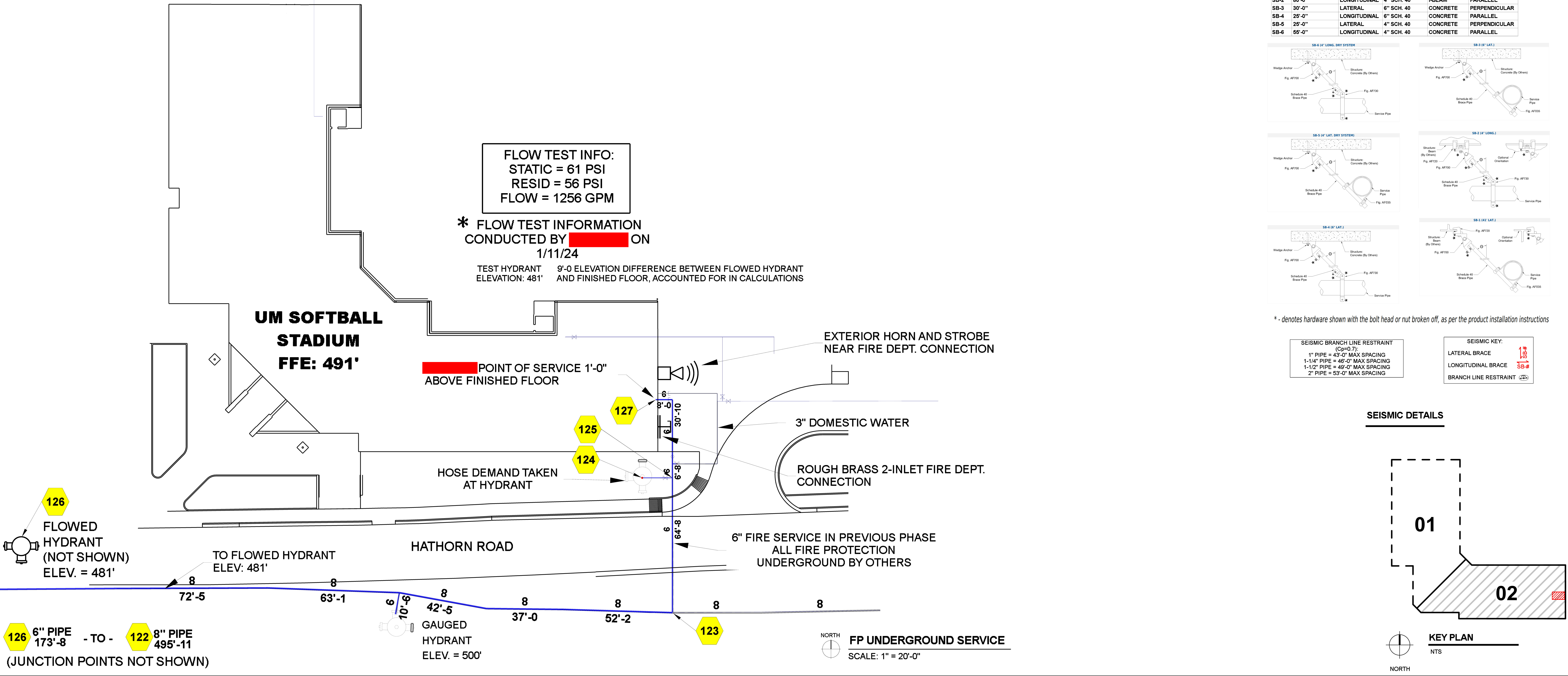

**SEISMIC BRACE DESCRIPTIONS**

NAME	MAX SPACING	BRACE TYPE	PIPE BRACED	STRUCTURE	ORIENTATION
SB-1	30'-0"	LATERAL	4" SCH. 40	I-BEAM	PERPENDICULAR
SB-2	80'-0"	LONGITUDINAL	4" SCH. 40	I-BEAM	PARALLEL
SB-3	30'-0"	LATERAL	6" SCH. 40	CONCRETE	PERPENDICULAR
SB-4	25'-0"	LONGITUDINAL	6" SCH. 40	CONCRETE	PARALLEL
SB-5	25'-0"	LATERAL	4" SCH. 40	CONCRETE	PERPENDICULAR
SB-6	65'-0"	LONGITUDINAL	4" SCH. 40	CONCRETE	PARALLEL

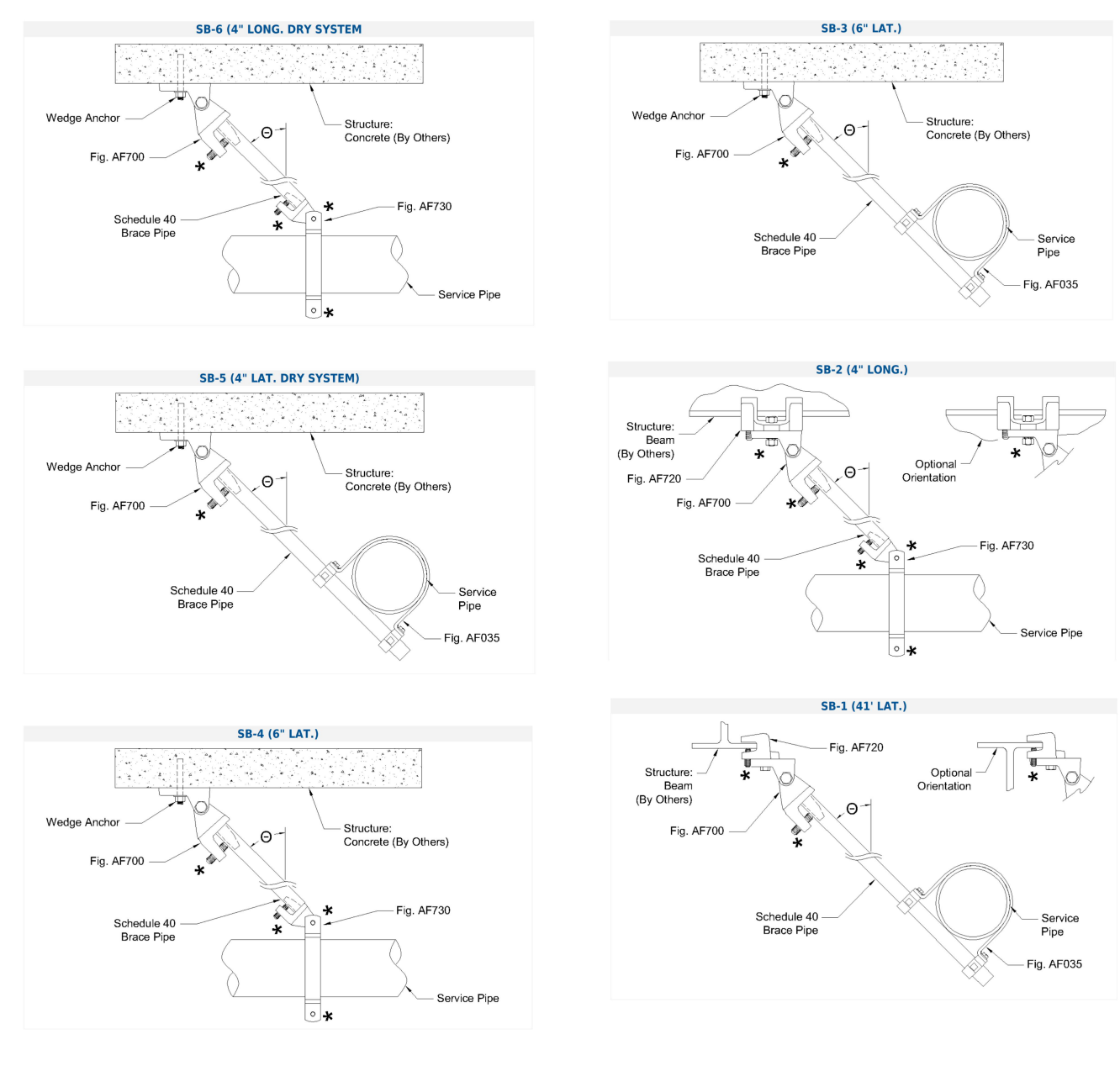

\* - denotes hardware shown with the bolt head or nut broken off, as per the product installation instructions

**SEISMIC BRANCH LINE RESTRAINT (Cp=0.7):**  
 1" PIPE = 45'-0" MAX SPACING  
 1-1/4" PIPE = 46'-0" MAX SPACING  
 1-1/2" PIPE = 49'-0" MAX SPACING  
 2" PIPE = 53'-0" MAX SPACING

**SEISMIC KEY:**  
 LATERAL BRACE  
 LONGITUDINAL BRACE  
 BRANCH LINE RESTRAINT

**SEISMIC DETAILS**

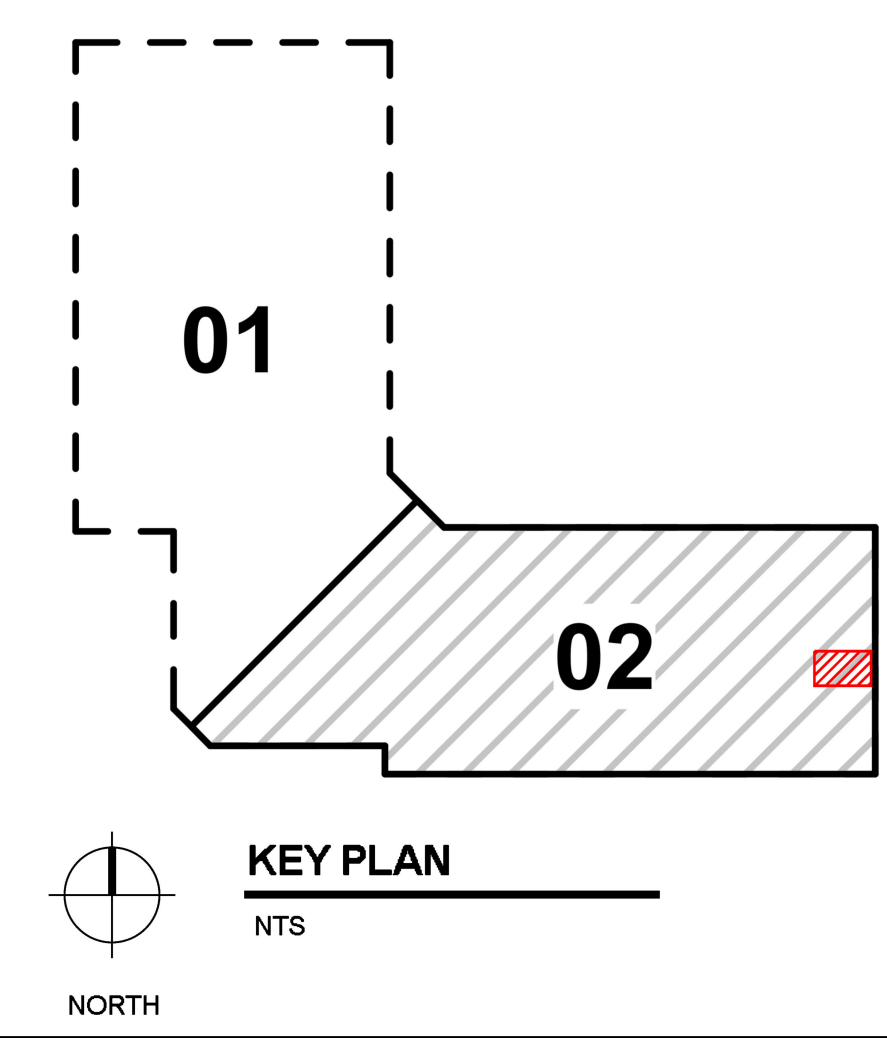

**REVISIONS**

NO.	DATE	BY
1		
2		
3		
4		
5		

THIS DRAWING ISSUED FOR:

- PRE-BID SCHEMATIC
- BID SCHEMATIC
- INSTALLATION
- AS-BUILT

**THE UNIVERSITY OF MISSISSIPPI**  
**SOFTBALL COMPLEX STADIUM (PHASE 4)**  
 971 HATHORN ROAD, UNIVERSITY, MISSISSIPPI  
 FIRE PROTECTION SITE PLAN AND DETAILS

DRAWN BY: WWWW  
 ISSUE DATE: 3/20/2024  
 SHEET NUMBER  
**FP1 OF 4**



Symbol	Manufacturer	SIN	Model	Quantity	K-Factor	Type	Size	Response	Finish	Temperature	Coverage	Notes
⊗	Viking	VK300	Microfast	115	5.6	Upright	1/2"	Quick	Brass	200°F	15' x 15'	N/A
⊗	Viking	VK4621	Microfast	103	5.6	Concealed Pendent	1/2"	Quick	Brass	200°F	15' x 15'	WHITE PLATE
⊗	Viking	VK302	Microfast	7	5.6	Pendent	1/2"	Quick	Brass	200°F	15' x 15'	N/A
⊗	Tyco	TY5339	DS-3	2	11.2	Horizontal Sidewall	1"	Standard	Brass	200°F	16' x 20'	DRY BARREL
⊗	Viking	VK305	Microfast	1	5.6	Horizontal Sidewall	1/2"	Quick	Brass	200°F	14' x 14'	N/A
				<b>Total = 228</b>								

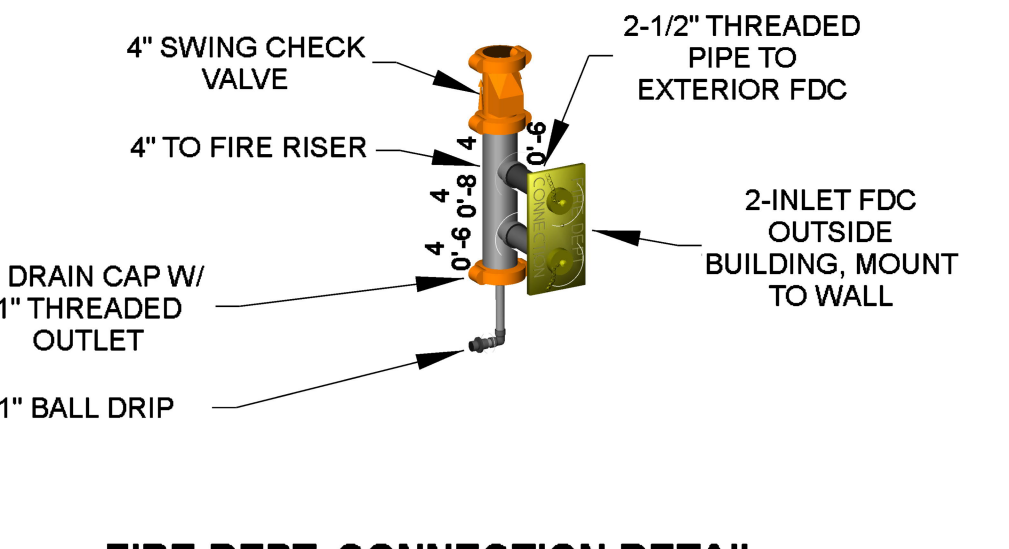
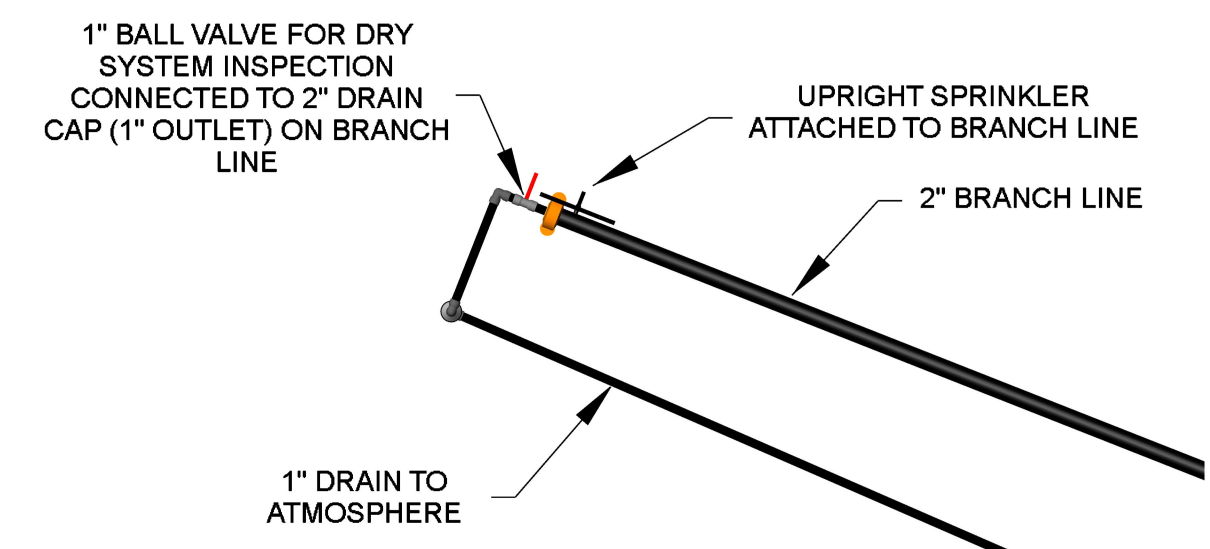
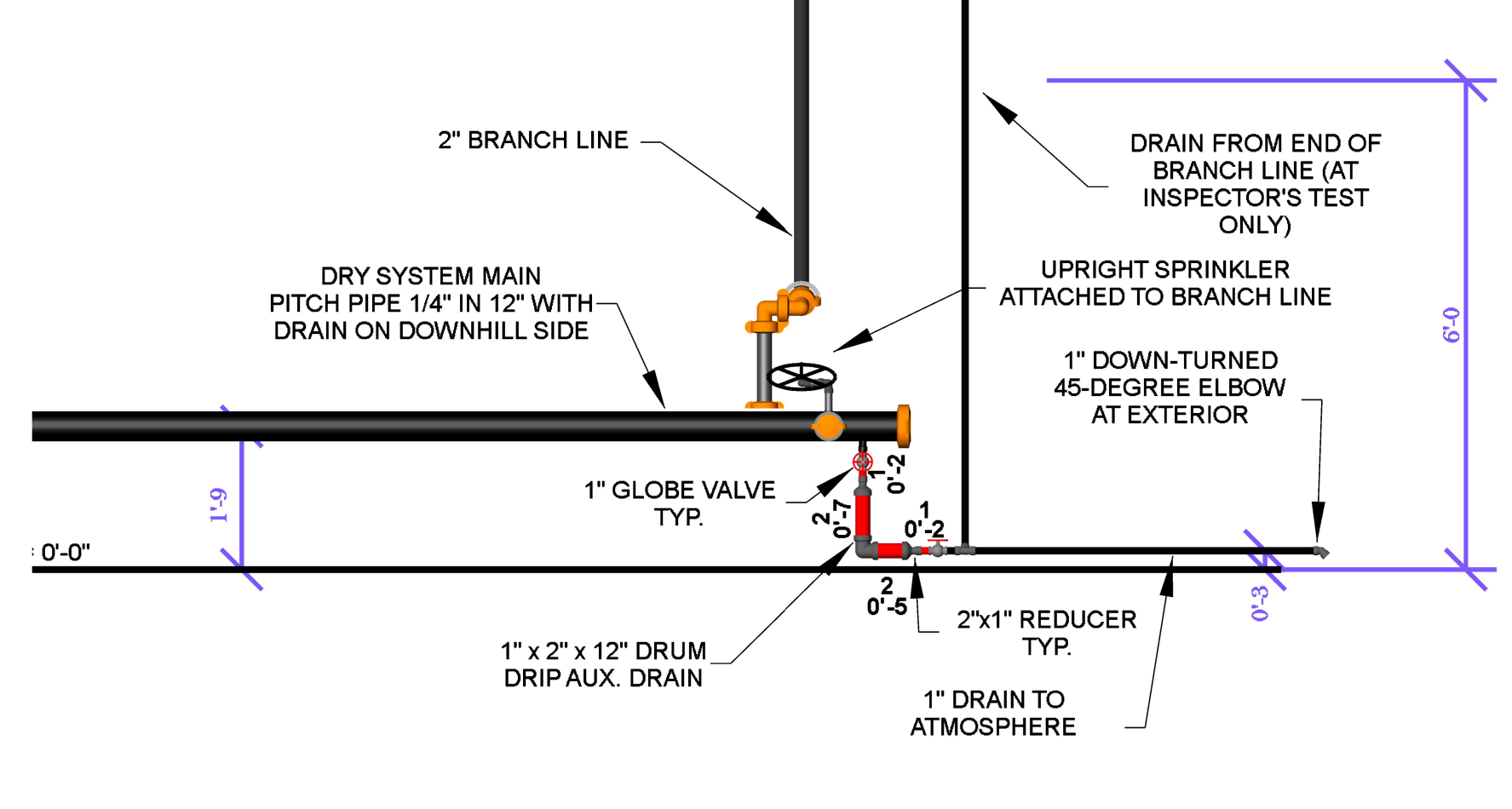
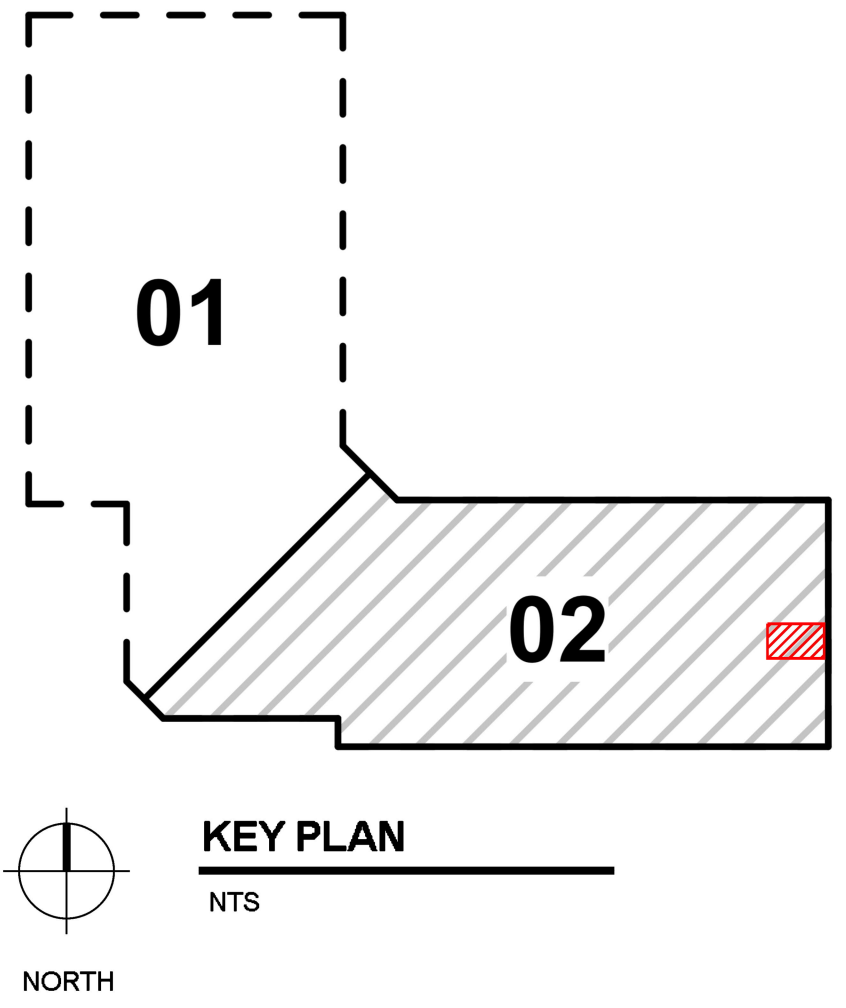

**Hydraulic Information**

Remote Area 1	
OCCUPANCY CLASSIFICATION	Ordinary Group I
DENSITY (ppm/ft²)	0.15 for 2535ft² (Actual 2580ft²)
TOTAL HOSE STREAMS	250.0
DRY CAPACITY	546gal
TOTAL HEADS FLOWING	24
K-FACTOR	5.6
TOTAL WATER REQUIRED	749.1
TOTAL PRESSURE REQUIRED	51.6
BASE OF RISER (ppm)	749.1
BASE OF RISER (psi)	51.6
SAFETY MARGIN (psi)	+7.5 (12.7%)
SAFETY MARGIN (ppm)	+6.4 (10.7%)

REMOTE AREA 1 WAS CALCULATED USING THE DENSITY/AREA METHOD PER NFPA 13 (2019) 16.3.3.2

**Hydraulic Information**

Remote Area 2	
OCCUPANCY CLASSIFICATION	Ordinary Group I
DENSITY (ppm/ft²)	0.15 for 1590ft² (Actual 1627ft²)
TOTAL HOSE STREAMS	250.0
TOTAL HEADS FLOWING	16
K-FACTOR	11.2
TOTAL WATER REQUIRED	602.5
TOTAL PRESSURE REQUIRED	53.3
BASE OF RISER (ppm)	602.5
BASE OF RISER (psi)	53.3
SAFETY MARGIN (psi)	+6.4 (10.7%)
SAFETY MARGIN (ppm)	+6.4 (10.7%)

REMOTE AREA 2 WAS CALCULATED USING THE DENSITY/AREA METHOD PER NFPA 13 (2019) 16.3.3.2

HOME LOCKER ROOM 016 AND MUD ROOM 026 ARE LIGHT HAZARD OCCUPANCIES

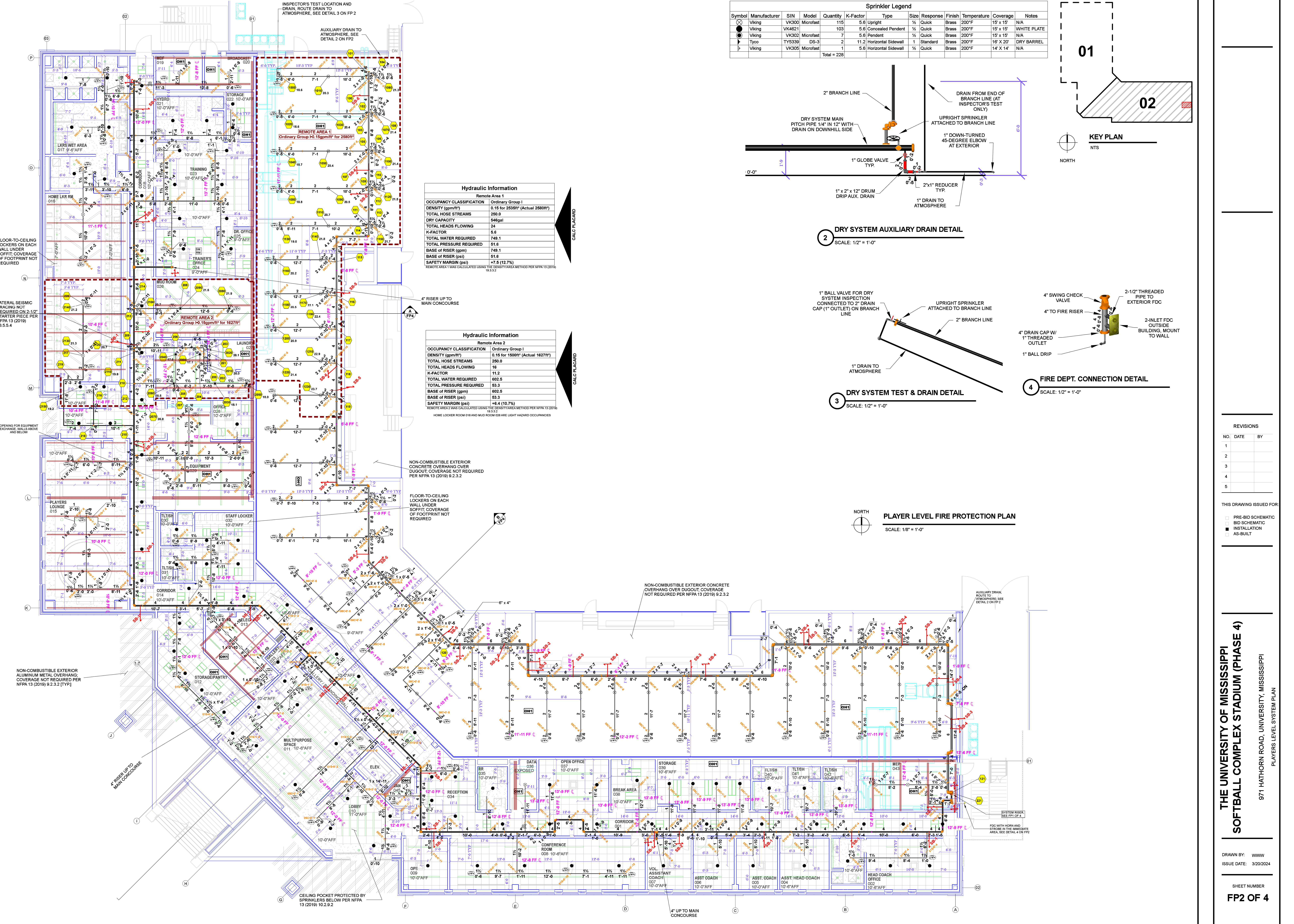

**REVISIONS**

NO.	DATE	BY
1		
2		
3		
4		
5		

THIS DRAWING ISSUED FOR:

- PRE-BID SCHEMATIC
- BID SCHEMATIC
- INSTALLATION
- AS-BUILT

**THE UNIVERSITY OF MISSISSIPPI**  
**SOFTBALL COMPLEX STADIUM (PHASE 4)**  
971 HATHORN ROAD, UNIVERSITY, MISSISSIPPI  
PLAYERS LEVEL SYSTEM PLAN

DRAWN BY: WWW  
ISSUE DATE: 3/20/2024  
SHEET NUMBER  
**FP2 OF 4**



Sprinkler Legend												
Symbol	Manufacturer	SIN	Model	Quantity	K-Factor	Type	Size	Response	Finish	Temperature	Coverage	Notes
●	Viking	VK4621		44	5.6	Concealed Pendant	1/2"	Quick	Brass	200°F	15' x 15'	WHITE PLATE
				Total = 44								

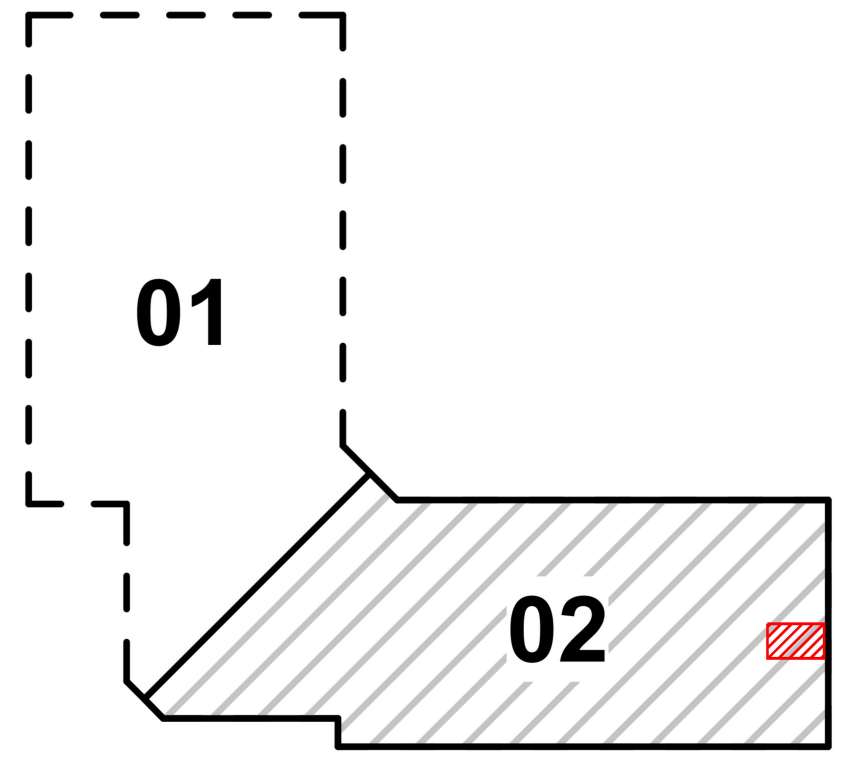

KEY PLAN  
NTS  
NORTH

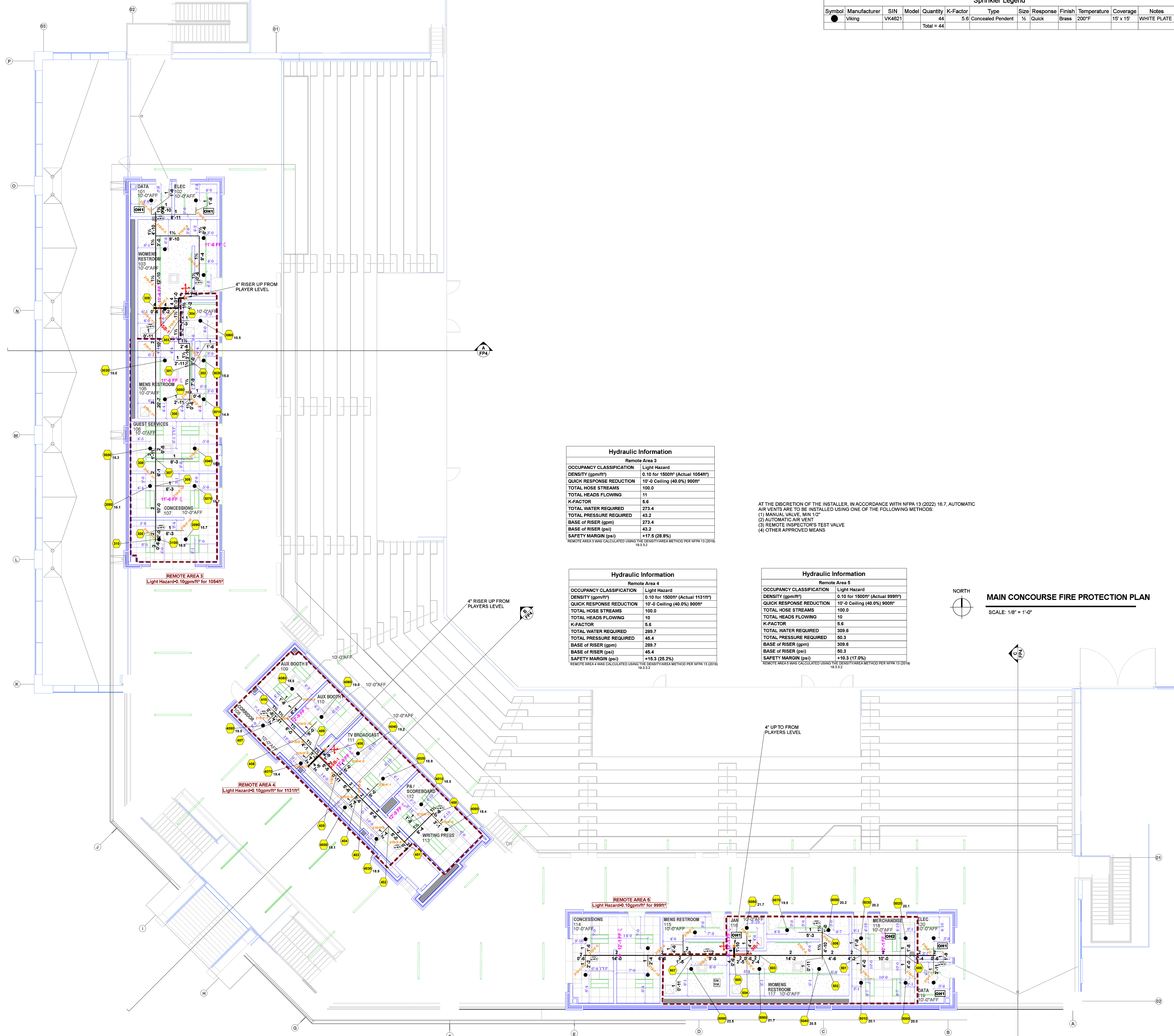

Hydraulic Information	
Remote Area 3	
OCCUPANCY CLASSIFICATION	Light Hazard
DENSITY (gpm/ft²)	0.10 for 1500ft² (Actual 1054ft²)
QUICK RESPONSE REDUCTION	10'-0" Ceiling (40.0%) 900ft²
TOTAL HOSE STREAMS	100.0
TOTAL HEADS FLOWING	11
K-FACTOR	5.6
TOTAL WATER REQUIRED	273.4
TOTAL PRESSURE REQUIRED	43.2
BASE OF RISER (gpm)	273.4
BASE OF RISER (psi)	43.2
SAFETY MARGIN (psi)	+17.5 (28.8%)
REMOTE AREA 3 WAS CALCULATED USING THE DENSITY/AREA METHOD PER NFPA 13 (2016) 19.3.3.2	

AT THE DISCRETION OF THE INSTALLER, IN ACCORDANCE WITH NFPA 13 (2022) 16.7, AUTOMATIC AIR VENTS ARE TO BE INSTALLED USING ONE OF THE FOLLOWING METHODS:  
(1) MANUAL VALVE, MIN 1/2"  
(2) AUTOMATIC AIR VENT  
(3) REMOTE INSPECTOR'S TEST VALVE  
(4) OTHER APPROVED MEANS

Hydraulic Information	
Remote Area 4	
OCCUPANCY CLASSIFICATION	Light Hazard
DENSITY (gpm/ft²)	0.10 for 1500ft² (Actual 1131ft²)
QUICK RESPONSE REDUCTION	10'-0" Ceiling (40.0%) 900ft²
TOTAL HOSE STREAMS	100.0
TOTAL HEADS FLOWING	10
K-FACTOR	5.6
TOTAL WATER REQUIRED	289.7
TOTAL PRESSURE REQUIRED	45.4
BASE OF RISER (gpm)	289.7
BASE OF RISER (psi)	45.4
SAFETY MARGIN (psi)	+15.3 (25.2%)
REMOTE AREA 4 WAS CALCULATED USING THE DENSITY/AREA METHOD PER NFPA 13 (2016) 19.3.3.2	

Hydraulic Information	
Remote Area 5	
OCCUPANCY CLASSIFICATION	Light Hazard
DENSITY (gpm/ft²)	0.10 for 1500ft² (Actual 999ft²)
QUICK RESPONSE REDUCTION	10'-0" Ceiling (40.0%) 900ft²
TOTAL HOSE STREAMS	100.0
TOTAL HEADS FLOWING	10
K-FACTOR	5.6
TOTAL WATER REQUIRED	308.6
TOTAL PRESSURE REQUIRED	50.3
BASE OF RISER (gpm)	308.6
BASE OF RISER (psi)	50.3
SAFETY MARGIN (psi)	+10.3 (17.0%)
REMOTE AREA 5 WAS CALCULATED USING THE DENSITY/AREA METHOD PER NFPA 13 (2016) 19.3.3.2	

NORTH  
MAIN CONCOURSE FIRE PROTECTION PLAN  
SCALE: 1/8" = 1'-0"

REVISIONS		
NO.	DATE	BY
1		
2		
3		
4		
5		

THIS DRAWING ISSUED FOR:  
 PRE-BID SCHEMATIC  
 BID SCHEMATIC  
 INSTALLATION  
 AS-BUILT

THE UNIVERSITY OF MISSISSIPPI  
SOFTBALL COMPLEX STADIUM (PHASE 4)  
971 HATHORN ROAD, UNIVERSITY, MISSISSIPPI  
MAIN CONCOURSE SYSTEM PLAN

DRAWN BY: WWWW  
ISSUE DATE: 3/20/2024

SHEET NUMBER  
FP3 OF 4



01

02

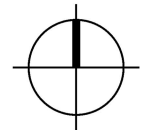

KEY PLAN

NTS

NORTH

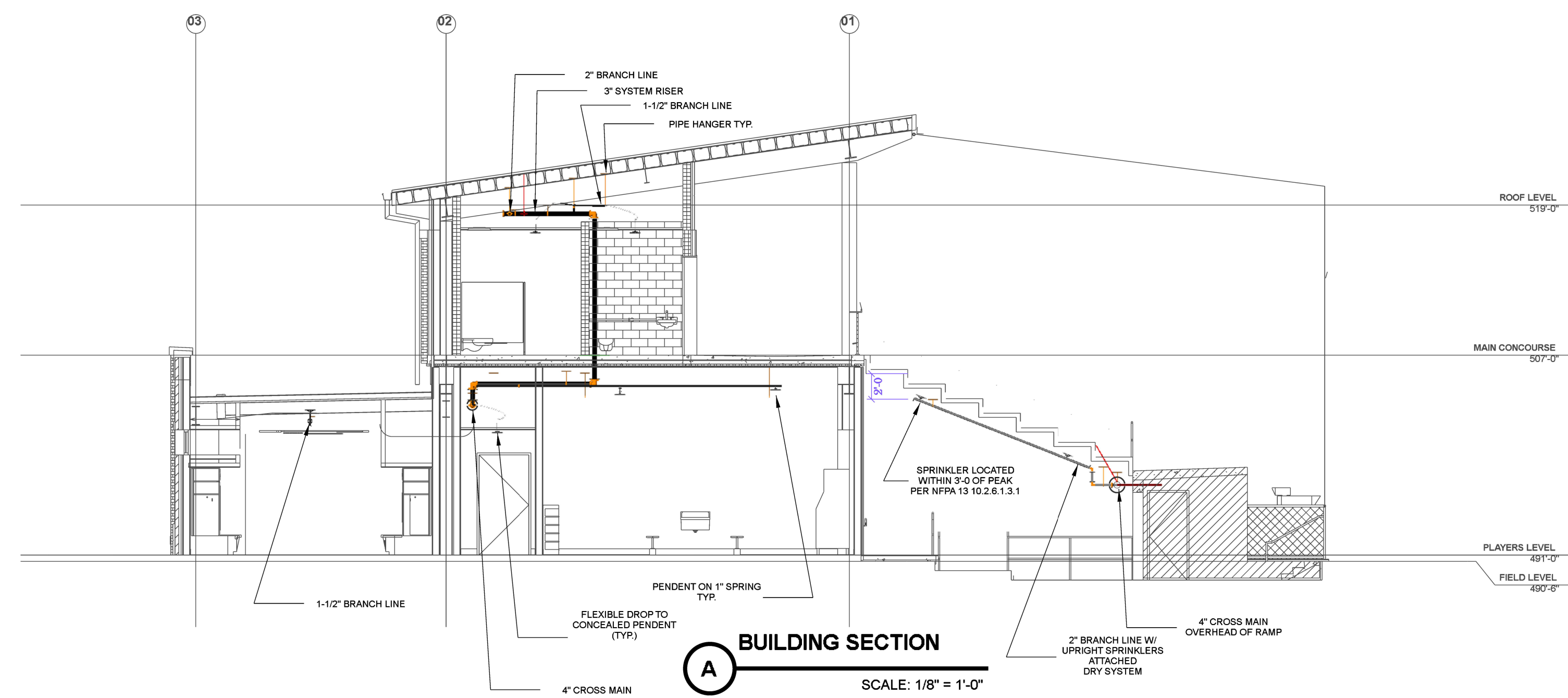
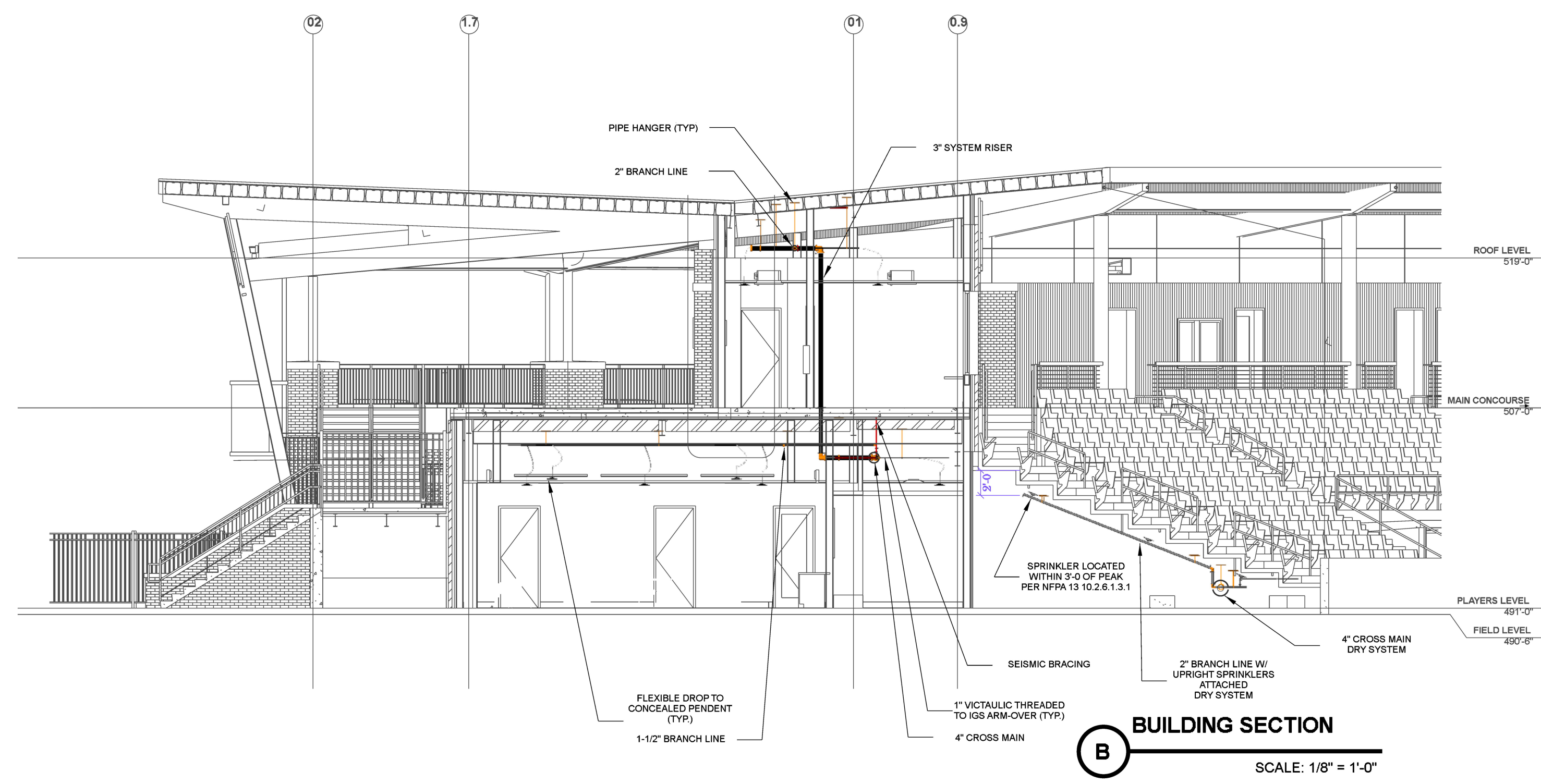
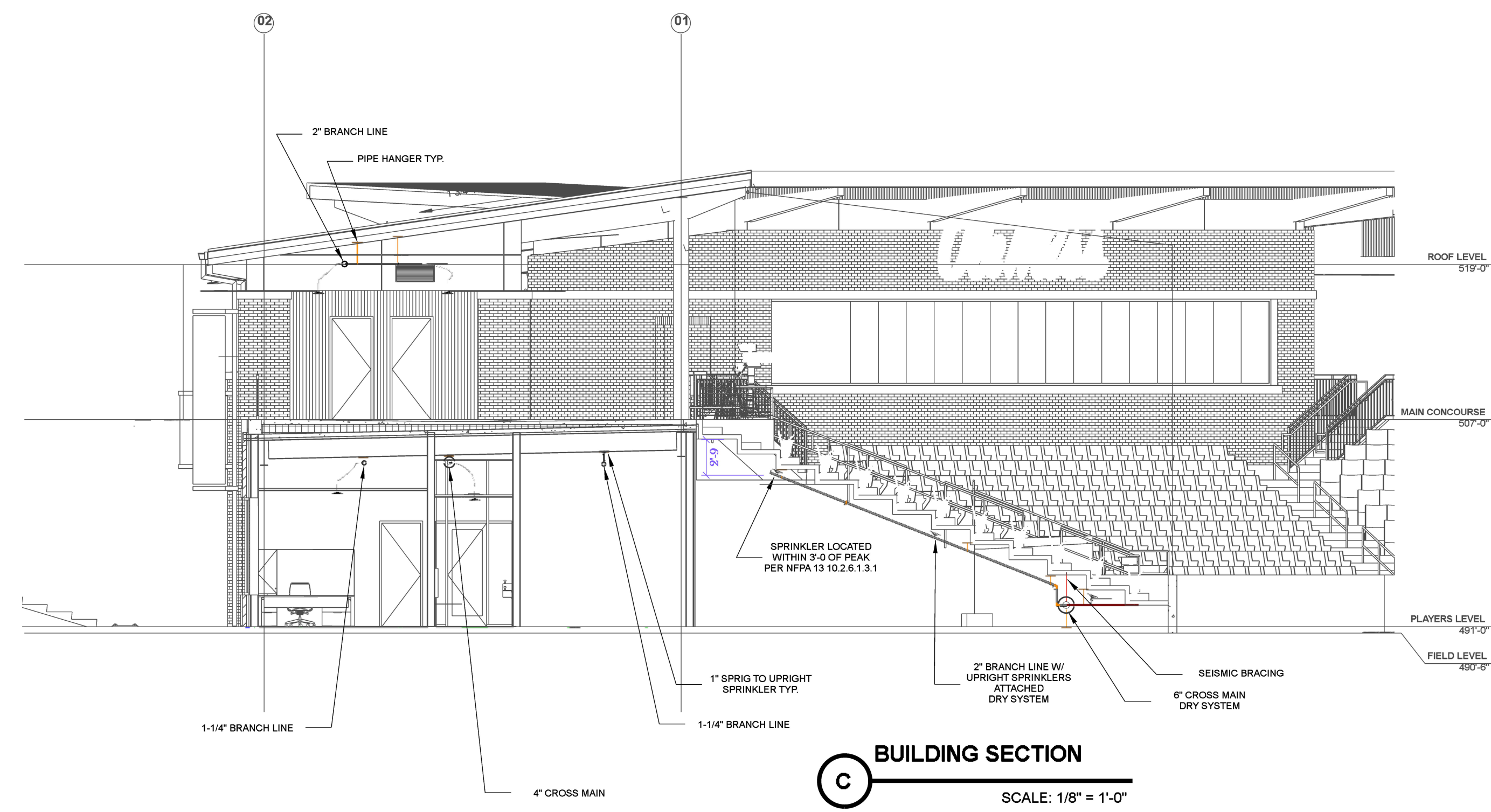

REVISIONS

NO.	DATE	BY
1		
2		
3		
4		
5		

THIS DRAWING ISSUED FOR:

- PRE-BID SCHEMATIC
- BID SCHEMATIC
- INSTALLATION
- AS-BUILT

**THE UNIVERSITY OF MISSISSIPPI  
SOFTBALL COMPLEX STADIUM (PHASE 4)**

971 HATHORN ROAD, UNIVERSITY, MISSISSIPPI

BUILDING SECTIONS

DRAWN BY: WWW  
ISSUE DATE: 3/20/2024

SHEET NUMBER  
**FP4 OF 4**